

User Information

Crank- turn-tilt fitting

light alloy window : F1200

timber window : F1280

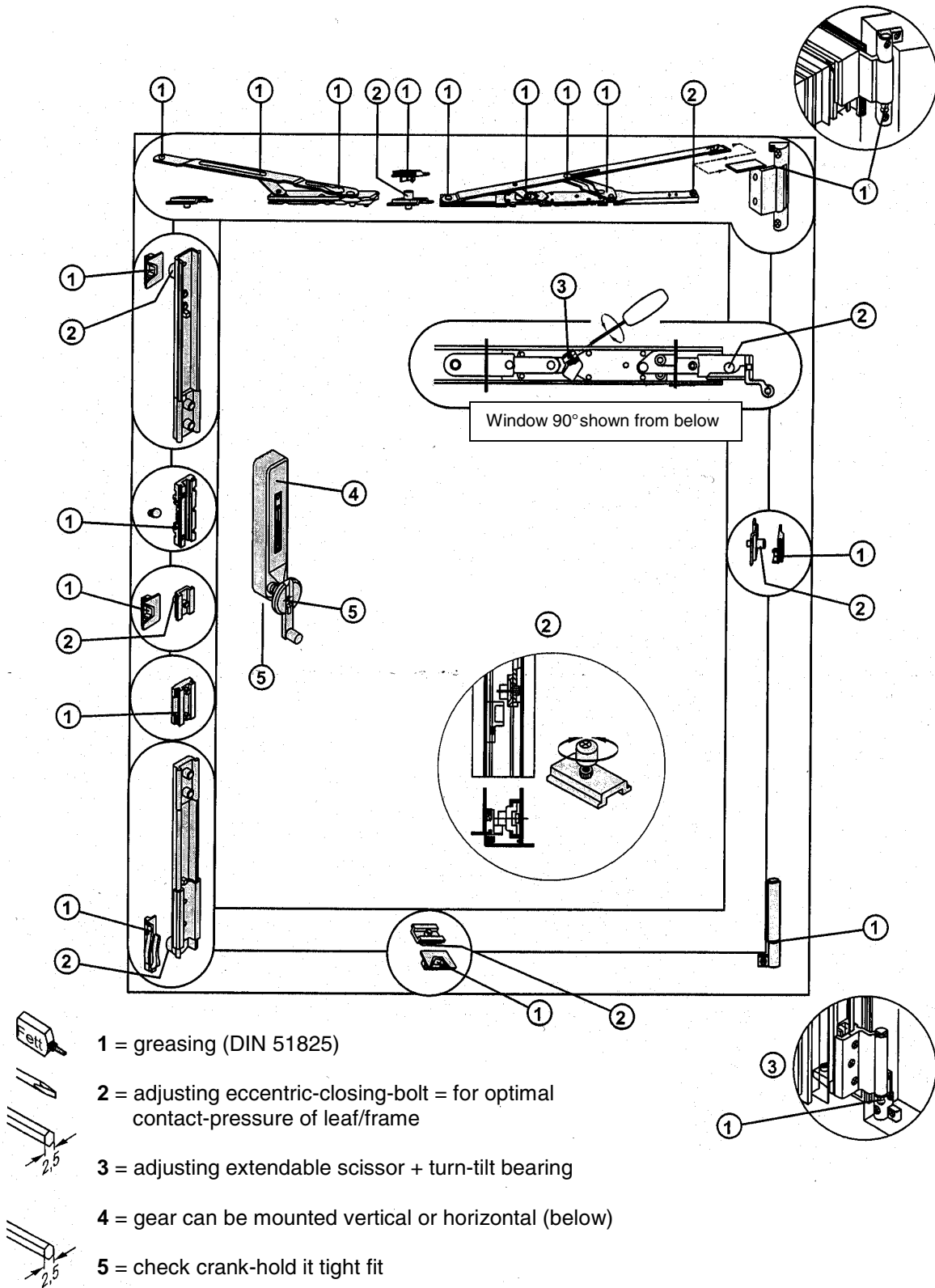

Maintenance

Ensure your GEZE hardware retain their ease of operation by greasing them occasionally (approximately once a year) where indicated ①. This also protects the locks from premature wear and tear.

Check regularly that all hardware components fit securely, are free from wear and tear and easy to operate (maintenance schedule: at last every 3 years for residential accommodation, 2 years for office and business premises, 1 year for schools, hospitals and hotels). If necessary, screw fittings should be tightened and any defective components replaced.

Subsequent adjustments, the replacement of components and the inside and outside hanging of opening casements should be performed by a specialist.

Window preparation and installation must be undertaken with great care by your professional window company and subsequent adjustments are therefore not generally necessary. Subsequent adjustments may however result from unforeseen changes to the housing or following long-term use. For this reason, check ease of operation when opening and closing and, if necessary, adjust at ② and ③.

Check closed casement of constant packing pressure at locking places. If necessary, adjust eccentric-closing-bolt.

! When painting wooden windows, ensure extending arms and hinges are free of paint.